

Slim Square Trimless Downlight Installation Guide

MRL-S430052, MRL-S445053

www.maxximastyle.com



WARNINGS



- Risk of fire or electric shock.
- If you are unfamiliar with electrical installations, consult a qualified electrician before proceeding.
- Turn power off from electrical panel before installation or maintenance.
- Do not make or alter any holes in the wiring enclosure or modify any electrical components.

CAUTIONS

- Intended for installation in accordance with local codes and the National Electric Code (NEC).
- This fixture is designed for use with 120VAC, 50/60Hz only.
- IC rated.
- Supply conductors must be rated for at least 90°C/194°F.
- Covered ceiling mount only.
- Suitable for wet locations.

INSTRUCTIONS

INSTALLATION:

1. Ensure that power has been turned off by switching the circuit breaker or by removing the fuse from the fuse panel.
2. If replacing a previous fixture, remove that light and ensure the hole in the ceiling corresponds to the correct cutout size, refer to figure 1.
3. Preview and select the desired color temperature for **each** LED head, see figure 2. Ensure each LED is the same CCT before installing.
4. Remove plaster frame from fixture. Run electrical wire from switch through mounting hole.
5. Align inside edge of plaster frame to the drywall hole and screw into place using supplied screws, see figure 3.
6. Plaster over the plaster frame, be careful not to fill past raised frame, see figure 4.
7. Open the junction box and remove the appropriate knockout(s) on the side panel.
8. Insert the electrical supply wires through the knockout and secure with a cable clamp (not provided).
9. Using the provided push in terminals, connect the ground wire to the green wire terminal, black wire to hot wire terminal, white wire to neutral wire terminal, shown in figure 5.
10. Place all wiring and connections into the junction box, ensuring none are pinched.
11. Insert junction box through mounting hole. Align connector from j-box into the connector from LED. Twist and lock the quick connect.
12. Insert the fixture to the plaster frame, ensure the fixture is secure, see figure 6.
13. Installation is now complete. Restore power and check operation of the light fixture.

Hole Cutout Size

2-Head Trimless	7 7/8" x 4 1/8" (200 x 105mm)
3-Head Trimless	11 5/8" x 4 1/8" (296 x 105mm)

Figure 1

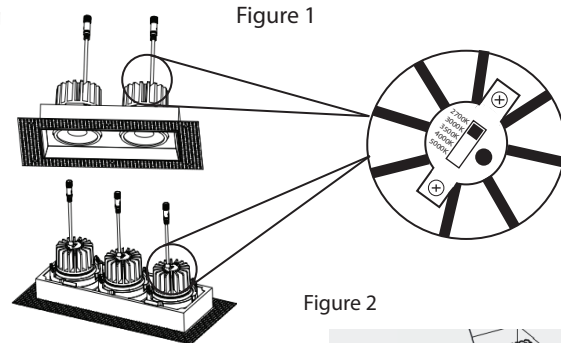

Figure 2

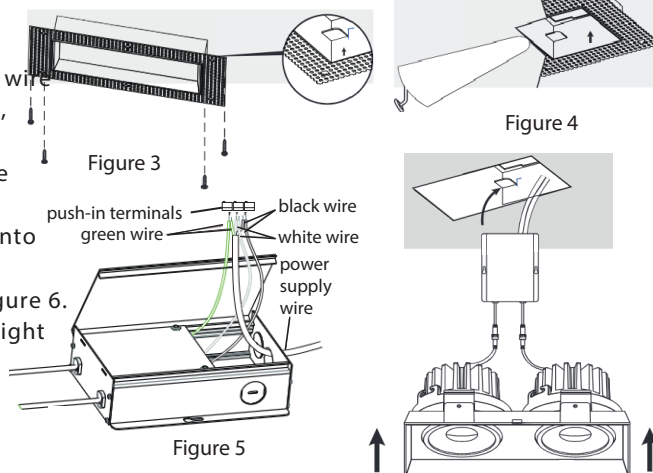

Figure 3

Figure 4

Figure 5

Figure 6

REMOVING FIXTURE:

1. Using supplied template, align with fixture.
2. Insert the supplied tool in "Hidden Tab" and gently push the tool up, removing the LED fixture out of the frame. If needed, insert tool on opposite side and repeat until fixture is removed, see figure 1A and 1B.

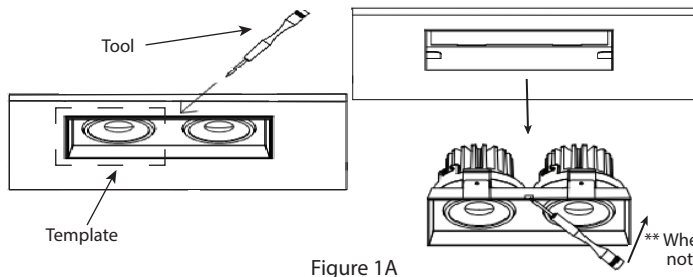

Figure 1A

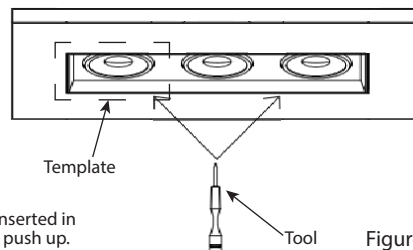

Figure 1B

3 YEAR WARRANTY

Maxxima extends a 3 year limited warranty to the original purchase that the products listed are free from defects in material and/or workmanship only. Maxxima will replace any warranted product to the original consumer/purchaser if the product fails because of defects due to workmanship and/or materials within the limited warranty period. Limited warranty is not transferable and applies to the original installation of the Maxxima product. This offer does not constitute in any way a product guarantee and Maxxima does not hereby assume any obligation whatsoever beyond sending a free replacement product.