



## Round LED Slim Gimbal Downlight Installation Guide

MRL-S20505

www.maxximastyle.com

### ⚠ WARNINGS ⚠

- Risk of fire or electric shock.
- If you are unfamiliar with electrical installations, consult a qualified electrician before proceeding.
- Turn power off from electrical panel before installation or maintenance.
- Do not make or alter any holes in the wiring enclosure or modify any electrical componentry.

### CAUTIONS

- Intended for installation in accordance with local codes and the National Electric Code (NEC).
- This fixture is designed for use with 120VAC, 50/60Hz only.
- Suitable for damp locations.
- Supply conductors must be rated for at least 90°C/194°F.

## INSTRUCTIONS

1. Ensure that power has been turned off by switching the circuit breaker or by removing the fuse from the fuse panel.
2. If replacing a previous fixture, remove that light and ensure the hole in the ceiling corresponds to the correct cutout diameter. If installing a new LED, cut correct hole diameter in the ceiling, as seen in figure 1.
3. Select the desired color temperature, as seen in figure 2.
4. Open the junction box and remove the appropriate knockout(s) on the side panel.
5. Insert the electrical supply wires through the knockout and secure with a cable connector (not provided).
6. Using the provided wire nuts, connect the ground wire to the green wire terminal, black wire to hot wire terminal, white wire to neutral wire terminal, shown in figure 3.
7. Place all wiring and connections into the junction box, ensuring none are pinched.
8. Insert junction box through mounting hole and push spring loaded clips upwards and insert fixture base into the mounting hole. Release clips and fixture will be pulled flush with ceiling, seen in figure 4.
9. Installation is now complete. Restore power and check operation of the light fixture.

Figure 1

	Hole Diameter
MRL-S20505	2", 57 mm

Figure 2

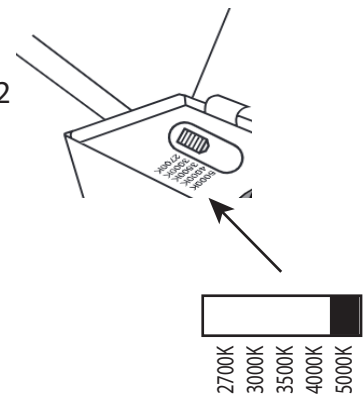
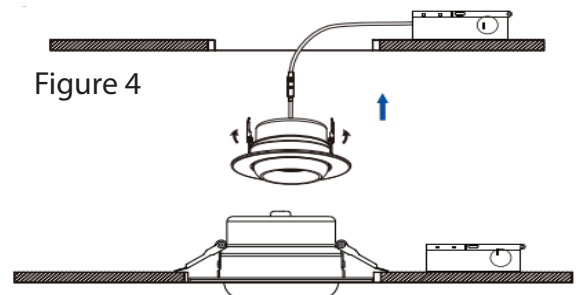

Figure 3



Figure 4



## 3 YEAR WARRANTY

Maxxima extends a 3 year limited warranty to the original purchase that the products listed are free from defects in material and/or workmanship only. Maxxima will replace any warranted product to the original consumer/purchaser if the product fails because of defects due to workmanship and/or materials within the limited warranty period. Limited warranty is not transferable and applies to the original installation of the Maxxima product. This offer does not constitute in any way a product guarantee and Maxxima does not hereby assume any obligation whatsoever beyond sending a free replacement product.